

# TLX5.7KK.3

## High Energy-optimized Compressor

### R600a

### 220-240V 50Hz

Data Sheet (Replaces CG.52.L1.02)

#### General

Compressor	TLX5.7KK.3
Code number	102H4647

#### Application

Application		LBP
Evaporating temperature range	°C	-35 to -10
Voltage range	V/Hz	198 - 254 /50
Motor type		RSCR*
Max. ambient temperature	°C	43
Comp. cooling at ambient temp.	32°C	S
	38°C	S
	43°C	S

\* run capacitor 4 µF compulsory

#### Design

Displacement	cm <sup>3</sup>	5.70
Oil quantity	cm <sup>3</sup>	180
Maximum refrigerant charge	g	150
Free gas vol. in compressor	cm <sup>3</sup>	1790
Weight without electrical equipment	kg	8.2

#### Motor

Motor size	watt	62
LRA (rated after 4 sec. UL984) LST	A	2.0
Cut-in current LST	A	5.5
Resistance, main and start winding (25°C)	Ω	37.0/21.0
Approvals		EN 60335-2-34 with Annex AA

#### Dimensions

Height	mm	A	173
		B	169
Suction connector	location/I.D. mm	C	6.2 ±0.09
Process connector	location/I.D. mm	D	6.2 ±0.09
Discharge connector	location/I.D. mm	E	5.0 +0.12/+0.20
Compressors on a pallet	pcs.		125

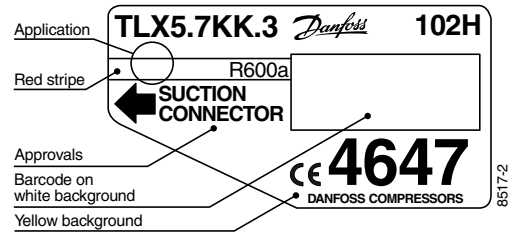

- S = Static cooling normally sufficient
- O = Oil cooling
- F<sub>1</sub> = Fan cooling 1.5 m/s  
(compressor compartment temperature equal to ambient temperature)
- F<sub>2</sub> = Fan cooling 3.0 m/s necessary

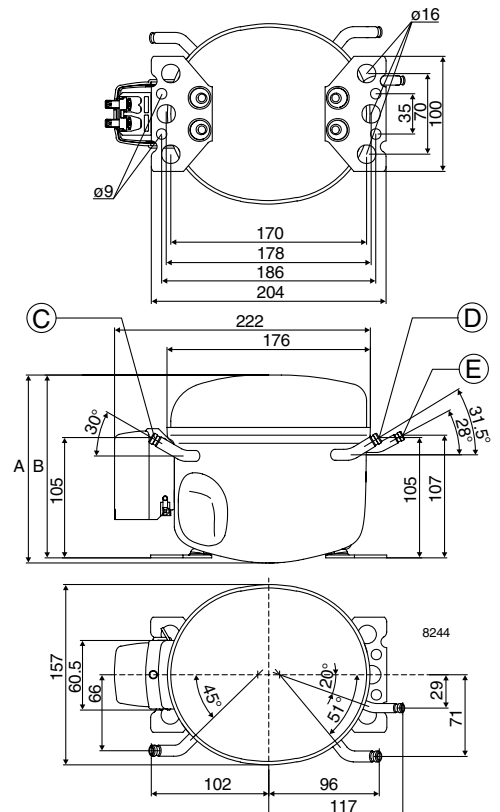

**Capacity (EN 12900/CECOMAF)**

**watt**

Comp.\°C	-35	-30	-25	-23.3	-20	-15	-10
TLX5.7KK.3	37.3	52.4	70.0	76.7	90.7	115	143

**Capacity (ASHRAE)**

**watt**

Comp.\°C	-35	-30	-25	-23.3	-20	-15	-10
TLX5.7KK.3	45.3	63.7	85.2	93.3	110	140	174

**Power consumption**

**watt**

Comp.\°C	-35	-30	-25	-23.3	-20	-15	-10
TLX5.7KK.3	40.6	47.8	54.7	57.1	61.7	69.2	77.5

**Current consumption**

**A**

Comp.\°C	-35	-30	-25	-23.3	-20	-15	-10
TLX5.7KK.3	0.23	0.25	0.28	0.29	0.32	0.35	0.39

**COP (EN 12900/CECOMAF)**

**W/W**

Comp.\°C	-35	-30	-25	-23.3	-20	-15	-10
TLX5.7KK.3	0.92	1.10	1.28	1.34	1.47	1.66	1.85

**COP (ASHRAE)**

**W/W**

Comp.\°C	-35	-30	-25	-23.3	-20	-15	-10
TLX5.7KK.3	1.12	1.33	1.56	1.63	1.79	2.02	2.25

Test conditions EN 12900/CECOMAF ASHRAE  
 Condensing temperature 55°C 55°C  
 Ambient and suction gas temp. 32°C 32°C  
 Liquid temperature 55°C 32°C  
 Static cooling, with RC 4 µF, 220V 50Hz.  
 ePTC power consumption included (two watt power consumption to be added, when standard PTC is used; this is also affecting the COP)

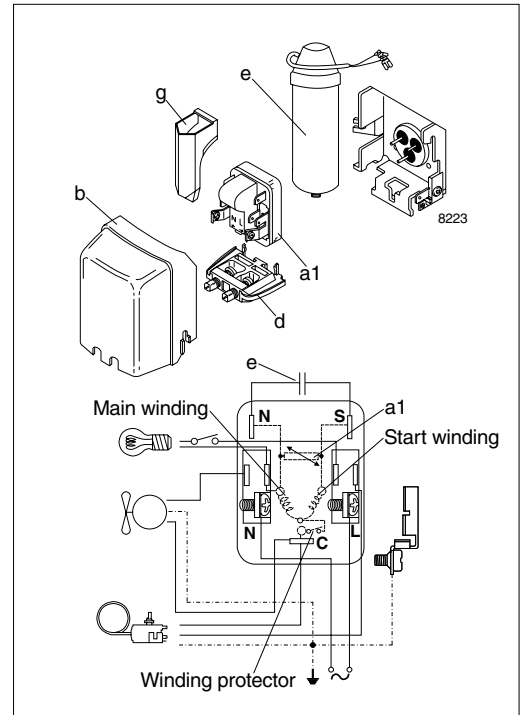

**Accessories**

Devices	Fig.	TLX5.7KK.3
ePTC starting device 4.8 mm spades	a1	103N0050
PTC starting device 6.3 mm spades		103N0016
4.8 mm spades		103N0021
Cover	b	103N2010
Cord relief	d	103N1010
Run capacitor 4 µF (compulsory)	e	117-7117
6.3 mm spades 4.8 mm spades		117-7119
Protection screen for PTC	g	103N0476
Mounting accessories		
Bolt joint for one compressor		118-1917
Bolt joint in quantities		118-1918
Snap-on in quantities		118-1919